

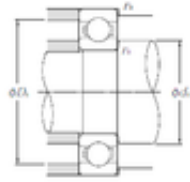

China 6205 Bearing Supplier

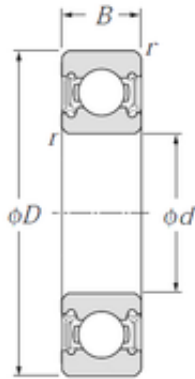

NTN Bearing 6209LLU Single Row Deep Groove Radial Ball Bearing 6209

Bearing No. 6209LLU

6209LLU Bearing 2D drawings and 3D CAD models

Size	45x85x19 mm
Bore Diameter	45 mm
Outer Diameter	85 mm
Width	19 mm
d	45 mm
D	85 mm
B	19 mm
C	19 mm
r min.	1,1 mm
da min.	51,5 mm
da max	55,5 mm
Da max.	78,5 mm
ra max.	1 mm
Weight	0,398 Kg
Basic dynamic load rating (C)	32,5 kN
Basic static load rating (C0)	20,4 kN
Reference speed	5 200 r/min
Category	Single Row Ball Bearings
Inventory	0.0
Manufacturer Name	NTN
Minimum Buy Quantity	N/A
Weight / Kilogram	0
EAN	4547359004748
Product Group	B00308
Enclosure	2 Seals



China 6205 Bearing Supplier

Precision Class	ABEC 1 ISO P0
Maximum Capacity / Filling Slot	No
Rolling Element	Ball Bearing
Snap Ring	No
Internal Special Features	No
Cage Material	Steel
Enclosure Type	Contact Seal
Internal Clearance	C0-Medium
Inch - Metric	Metric
Long Description	45MM Bore; 85MM Outside Diameter; 19MM Outer Race Width; 2 Seals; Ball Bearing; ABEC 1 ISO P0; No Filling Slot; No Snap Ring; No Internal Special Features; C0-Medium Internal Clearance; Steel Cage;
Other Features	Deep Groove Double Lip Friction Nitrile Rubber Seal -20 To 120 Deg C Shell Alvania Prelubricated
Category	Single Row Ball Bearing
UNSPSC	31171504
Harmonized Tariff Code	8482.10.50.68
Noun	Bearing
Keyword String	Ball
Manufacturer URL	http://www.ntnamerica.com
Weight / LBS	0.897
Bore	1.772 Inch 45 Millimeter
Outer Race Width	0.748 Inch 19 Millimeter
Inner Race Width	0 Inch 0 Millimeter
Outside Diameter	3.346 Inch 85 Millimeter
bore diameter:	45 mm



China 6205 Bearing Supplier

precision rating:	ISO Class 0
outside diameter:	85 mm
finish/coating:	Uncoated
overall width:	19 mm
bearing material:	High Carbon Chrome Steel
bore type:	Round
cage material:	Steel
closure type:	Double Sealed
inner ring width:	19 mm
row type & fill slot:	Single Row Non-Fill Slot
outer ring width:	19 mm
snap ring included:	Without Snap Ring
maximum rpm (grease):	5200 rpm
internal clearance:	CN
fillet radius:	1.1 mm
operating temperature range:	-40 to 120 ° C
maximum rpm:	9200 RPM
dynamic load capacity:	32500 N
series:	62
static load capacity:	20400 N
manufacturer product page:	Click here